

Third Floor - GIA = 1236sqm

Service - Adult Social Care & Health (ASCH)

Team Zone:

- Dedicated Work Area of 272sqm
- Approximately 56 work spaces

Third Floor - GIA = 1236sqm

Service - CST

Team Zone:

- Dedicated Work Area of 370sqm
- Approximately 76 work spaces

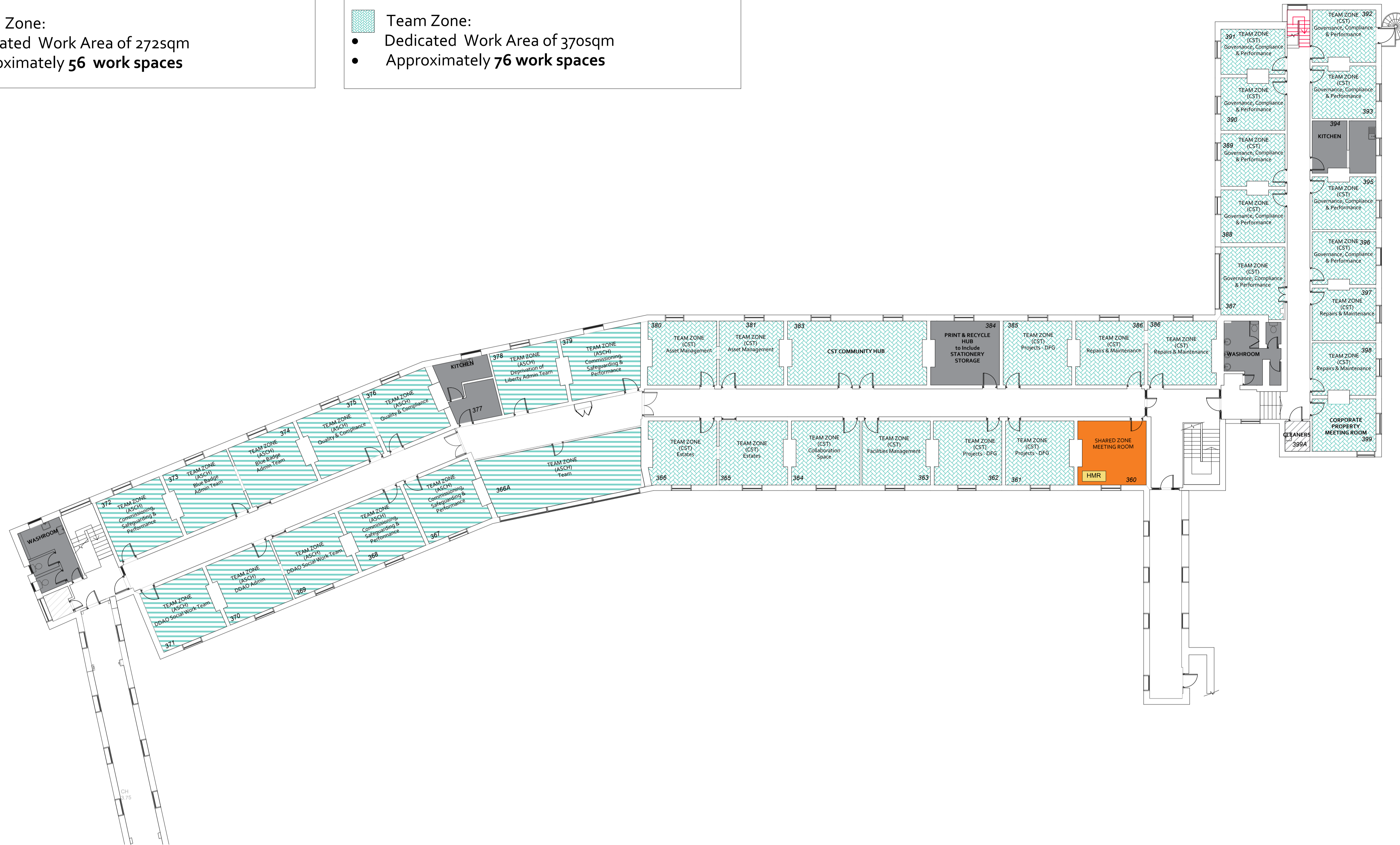

KEY

Shared Zone

HMR Hybrid Meeting Room

- Team Zone - ASCH**
- Blue Badge Admin Team - 8 Work Spaces
 - Commissioning, Safeguarding & Performance - 16 Work Spaces
 - Quality & Compliance - 8 Work Spaces
 - Deprivation of Liberty Admin Team - 3 Work Spaces
 - DDAO Social Work Team - 8 Work Spaces
 - DDAO Admin - 4 Work Spaces
 - Team - 9 Work Spaces

- Team Zone - CST**
- Asset management - 8 Work Spaces
 - Projects DFG - 12 Work Spaces
 - Repairs & Maintenance - 14 Work Spaces
 - Facilities Management - 4 Work Spaces
 - Governance, Compliance & Performance - 26 Work Spaces
 - Estates - 8 Work Spaces
 - Collaboration Space - 4 Work Spaces

- Facilities**
- 2 x Kitchen
 - Toilets
 - Print & Recycle Hub

- Restricted / Mechanical Facilities**
- Boiler / Plant Room
 - Electrical Room
 - Cleaners Store

Modern Ways of Working - Phase 1
County Hall - North Block
Third Floor
Scale 1:150 @ A1
29/06/22 Rev:12